

IP54 Fan and Filter

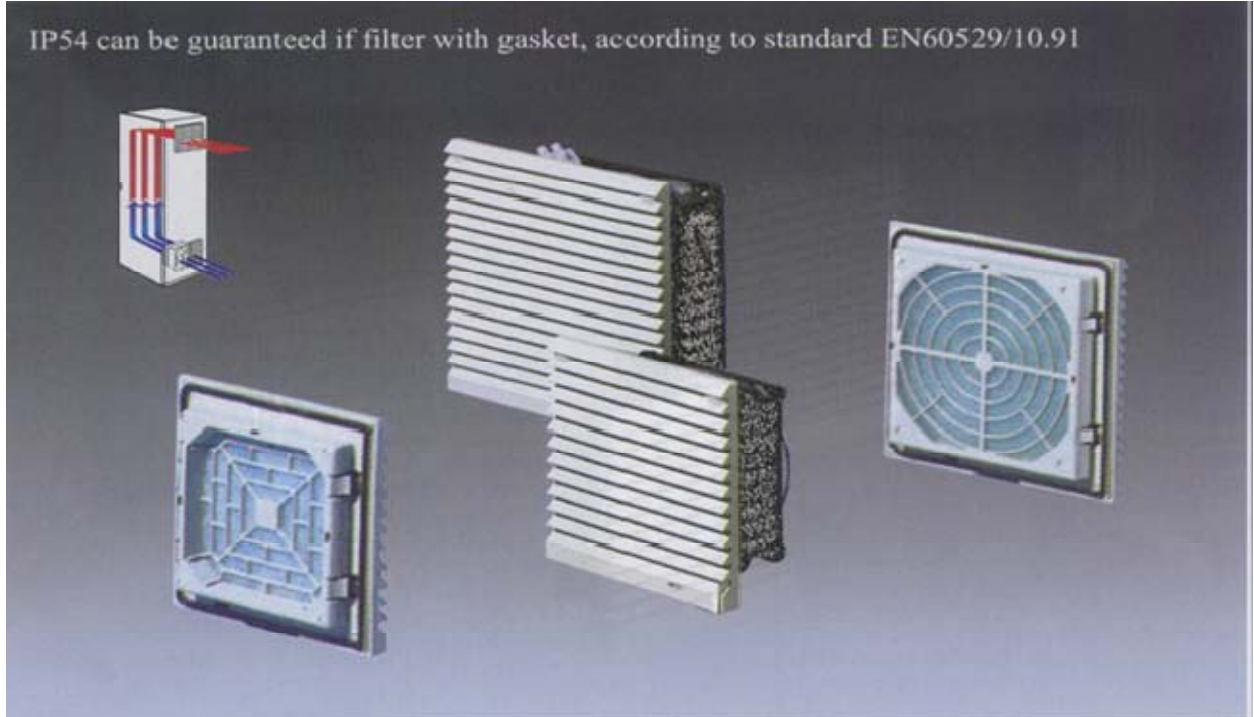

Former type Fan and filter **From now on:** **FKL 3321....**

Fan and filter **FKL 3321.100**

Exit filter **FKL 3321.200**

Installing section **FKL 3321....**

Power specific property curve
FKL 3321....

Fan and filter	Type	FKL 3321.100	3321.115	3321.024
Designed working voltage V/H		230/50/60	115/50/60	24(DC)
Air flow, free blowing		20/25m ³ /h		
Flux of air - equip filter exported Include filtering pad of standard		1 × FK 3321.200: 15/18m ³ /h		
Axial fan		Self-start screened magnetic pole motor		Direct current motor
Rated current		0.08A	0.16A	0.18A
Power		16W/14W	16W/14W	4.3W
Noise level		41/46dB(A)		
Scope of temperature		-10°C ~ +55°C		
Exit filter	Type	FKL 3321.200		

It is possible to write to our company to consult if needing special voltage.

Type FKL3321.200

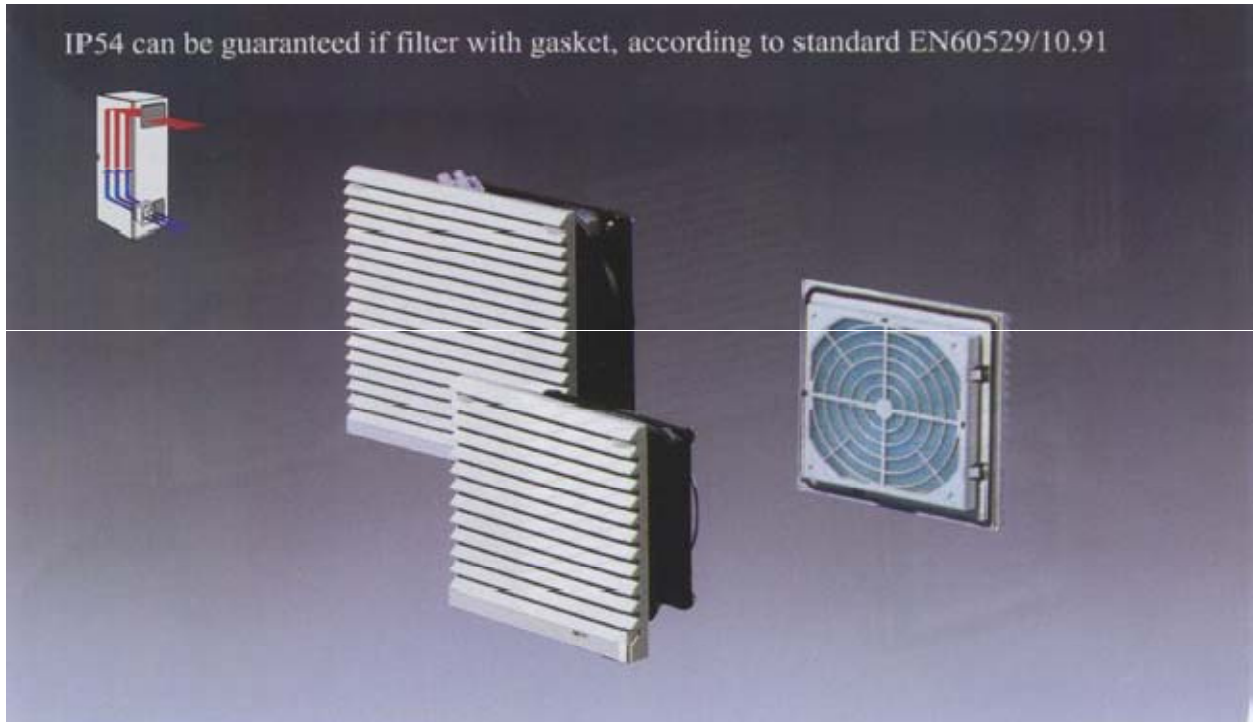

Former type Fan and filter: **From now on: FKL 3322....**

Fan and filter: **FKL 3322.100**

Exit filter: **FKL 3322.200**

Installing section: **FKL 3322....**

Power specific property curve **FKL 3322....**

Fan and filter	Type	FKL	3322.100	3322.115	3322.024
Designed working voltage V/H			230/50/60	115/50/60	24(DC)
Air flow, free blowing			55/66m³/h		
Flux of air - equip filter exported			1 x FK 3322.200:43/50m³/h		
Include filtering pad of standard			2 x FK 3322.200:48/55m³/h		
			1 x FK 3322.200:48/55m³/h		
Axial fan			Self-start screened magnetic pole motor		Direct current motor
Rated current			0.12A	0.24A	0.15A
			0.11A	0.23A	
Power			19W/18W	19W/18W	3.5W
Noise level			46/49dB(A)		
Scope of temperature			-10°C--+55°C		
Exit filter	Type	FKL	3322.200		

It is possible to write to our company to consult if needing special voltage.

Type FKL3322.200

IP54 can be guaranteed if filter with gasket, according to standard EN60529/10.91

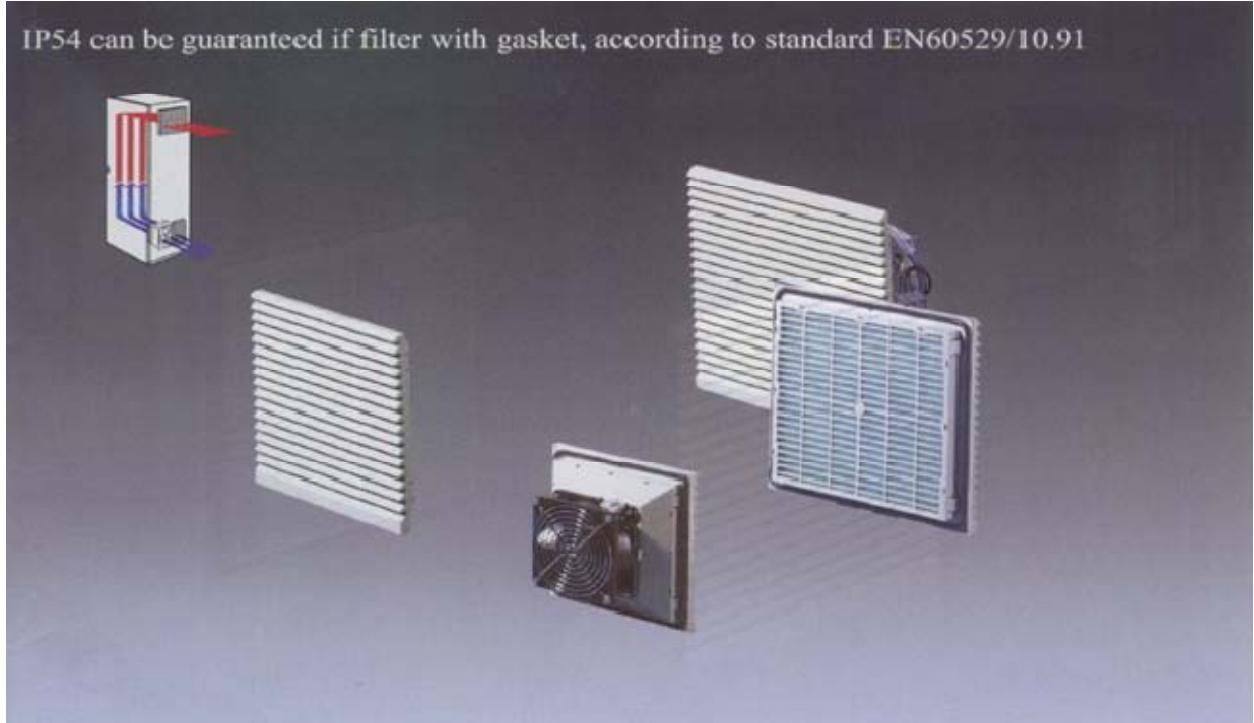

Former type
From now on: **FKL 3323....**

Fan and filter
FKL 3323.100

Fan and filter
FKL 3323.115

Exit filter
FKL 3323.200

Installing section
FKL 3323....

Power specific property curve
FKL 3323....

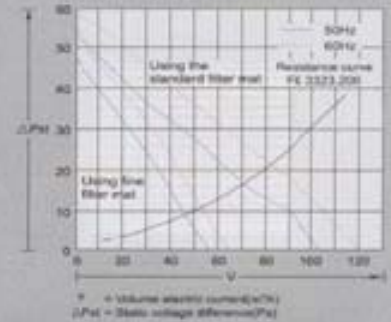
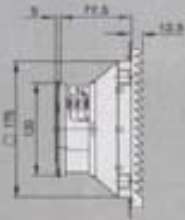

Fan and filter	Type	FKL	3323.100	3323.115	3323.024
Designed working voltage V/H			230/50/60	115/50/60	24(0C)
Air flow, free blowing			105/120m³/h		
Flux of air - equip filter exported include filtering pad of standard			1 x FKL 3323.200:71/82m ³ /h 2 x FKL 3323.200:85/96m ³ /h 1 x FKL 3323.200:76/90m ³ /h		
Axial fan			Self-start screened magnetic pole motor		Direct current motor
Rated current			0.12A 0.11A	0.24A 0.23A	0.15A
Power			19W/18W		3.5W
Noise level			46/49dB(A)		
Scope of temperature			-10°C - +55°C		
Exit filter	Type	FKL	3323.200		
It is possible to write to our company to consult if needing special voltage.					

Type FKL3323.200

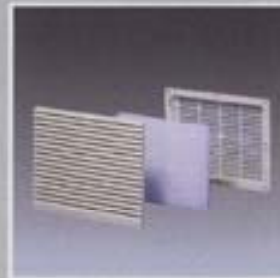



Former type Fan and filter
From now on: FKL 3325....

Fan and filter
FKL 3325.100

Exit filter
FKL 3325.200

Installing section
FKL 3325....

Power specific property curve
FKL 3325....

Fan and filter	Type FKL	3325.100	3325.115	3325.024
Designed working voltage V/H		230/50/60	115/50/60	24(DC)
Air flow , free blowing		230/265m³/h		
Flux of air equip filter exported include filtering pad of standard		1 × FK 3325.200:170/205m³/h 2 × FK 3325.200:200/230m³/h 1 × FK 3325.200:190/215m³/h		
Axial fan		Self-start screened magnetic pole motor		Direct current motor
Rated current		0.28A	0.53A	0.58A
		0.24A	0.49A	
Power		41W/38W	41W/38W	14W
Noise level		54/56dB(A)		
Scope of temperature		-10°C ~ +55°C		
Exit filter	Type FKL	3325.200		

It is possible to write to our company to consult if needing special voltage.

Type FKL3325.200