



Spare parts suitable for:
CAB

C

Suitable for CAB

Spare parts suitable for drink dispenser



G.E.V. Großküchen-Ersatzteil-Vertrieb GmbH
Robert-Koch-Straße 3a
82152 Planegg/Munich
Germany

Phone: +49 (0)89 745572-0
Fax: +49 (0)89 745572-83
order@gev-online.com
www.gev-online.com

Member of the  **GEV GROUP**

electrical components



item	order no.	description	type	ref. no.
1	346066	switch 0-1	Luke 1-4, Faby 1-3, Fast Cold 1-3	L8119, F131
2	345575	changeover switch 1-0-2	Faby 1-3	F133
3	301013	switch 0-1	Faby 1-3, Fast Cold 1-3	F132
4	301188	changeover switch 1-0-2	Faby 2/3	1350



item	order no.	description	type	ref. no.
1	601133	enclosed fan	Faby 1	F067
2	601388	enclosed fan	Faby 1	F067/4



item	order no.	description	type	ref. no.
1	390522	thermostat	Luke 1-4, Faby 1-3, Fast Cold 1-3	1025
2	370392	solenoid valve body		1183
3	371189	solenoid coil		1285

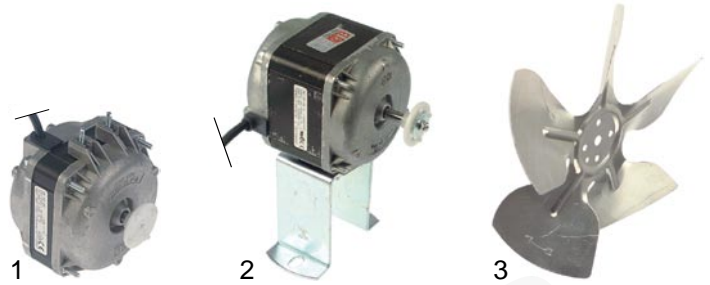

item	order no.	description	type	ref. no.
1	601430	motor	Fast Cold 1	5045
	601427	motor 10W	Luke 3/4, Fast Cold 2	5010
2	601433	motor 16W	Faby 2	1099
	601380	motor	Faby 3	1113
3	601385	fan blade 170mm 34°	Luke 2, Fast Cold 1	L8022
	601070	fan blade 200mm 28°	Luke 3	L8055
	601071	fan blade 230mm 28°	Fast Cold 2	1244
	601386	fan blade 230mm 28°, pushing	Luke 4	L8092
	601284	fan blade 254mm 28°	Faby 2	1100
	601387	fan blade 254mm 34°	Faby 3	1112

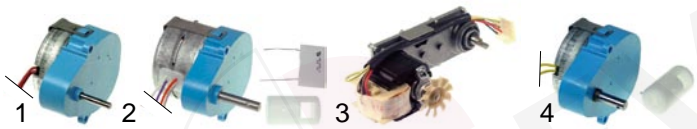

item	order no.	description	type	ref. no.
1	500911	gear motor 230V, shaft ø 4mm	Luke 1-4 (till 01.01)	L8102
	500907	gear motor 230V, shaft ø 6mm	Luke 1-4 (from 01.01)	P201, L8102/2;1
2	500908	gear motor 24V	Faby 1-3	F023/3
3	500909	gear motor 230V	Faby 1-3	F033/1
4	500910	gear motor 12V	Fast Cold 1-3	FB209

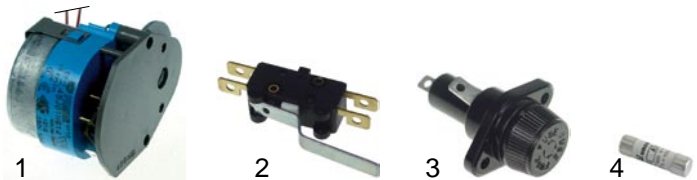

item	order no.	description	type	ref. no.
1	360364	timer 230V		1016
2	346865	micro switch		1061/UL
3	358535	fuse holder	Faby 1-3	1240
	358022	fuse 4A		F147
4	358027	fuse 16A		1027
	358032	fuse 25A		1237



pos.	order no.	description	type	ref. no.
1	605006	compressor	Fast Cold 1	FB018
2	605017	compressor	Luke 2	L8113/1, L8113/3
3	605016	compressor	Luke 3/4, Fast Cold 2	L8116/2
4	605018	compressor	Faby 1, Fast Cold 3	F061/1, F241
5	605005	compressor	Faby 2	F213
6	605019	compressor	Faby 3	F214

Suitable for CAB

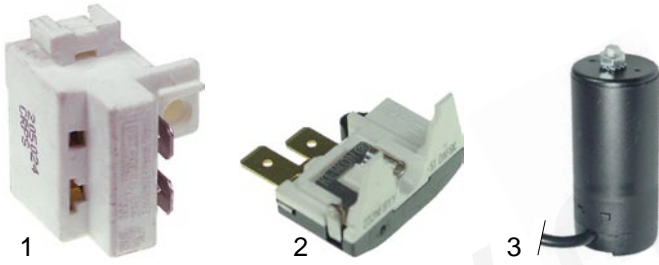

item	order no.	description	type	ref. no.
1	380072	starting relay	Fast Cold 1	FB019
	380071	starting relay	Luke 2	L40
	380070	starting relay	Luke 3/4, Fast Cold 2	L51
	380068	starting relay	Faby 1, Fast Cold 3	F061/3, F061/6
	380067	starting relay	Faby 2	F081/3
	380069	starting relay	Faby 3	F081/4
	390572	Klixon	Fast Cold 1	FB020
	390575	Klixon	Luke 2	L39
	390573	Klixon	Luke 3/4, Fast Cold 2	L52
	2	390571	Klixon	Faby 1, Fast Cold 3
390576		Klixon	Faby 2	F082/3
390574		Klixon	Faby 3	F082/2, F082/4
3	365055	starting capacitor	Faby 1, Fast Cold 3	F061/4, F061/7
	365057	starting capacitor	Faby 2	F083/3
	365056	starting capacitor	Faby 3	F083/4

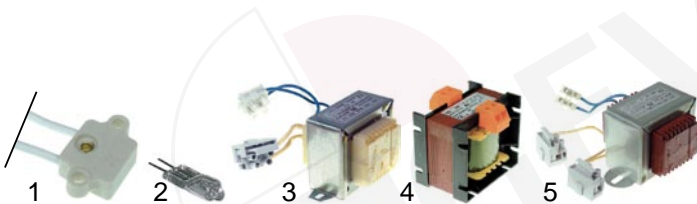

item	order no.	description	type	ref. no.
1	359939	bulb socket		F089
2	359599	lamp 12V	Fast Cold 1-3, Faby 1-3	1236
3	401593	transformer 60VA/11,5V	Fast Cold 1/2, Faby 1-3	FB017, F049/4
4	401602	transformer 80VA/11,5V	Fast Cold 3	FB23
5	401594	transformer 75VA 12/24V	Faby 1-3	F056/3, F049/1, F049/2, F121/2, F279

mechanical components



item	order no.	description	type	ref. no.
1	650053	lid	Luke 1-4	L8006B
	650018	container 6l		L8007
2	650017	container 9l		L8098
	532515	gasket		L8008



item	order no.	description	type	ref. no.
1	650025	agitator arm 6l		L8001
	650024	agitator arm 9l		L8099
2	650033	agitator 6l		L6102
	650029	agitator 9l	Luke 1-4	L6124
3	650032	bearing bush		1041
4	750185	evaporator 6l		LEV6LT
	750186	evaporator 9l		LEV9LT



item	order no.	description	type	ref. no.
1	650049	drain pipe		L8011
2	532514	gasket		5034
3	691112	spring		L8014
4	650046	bush	Luke 1-3	7510
5	650059	lever		L8017BLU
6	650027	drying basin		L8033BLU
7	650028	drying grid		L8034BLU



item	order no.	description	type	ref. no.
1	650060	lid in the front, blue	Faby 1-3, Fast Cold 1-3	F001BM(SF)
2	650061	lid in the front, yellow		F001/Y(SF)
3	650062	lid in the front, black		F001/N



item	order no.	description	type	ref. no.
1	650094	lid blue, complete		F301
2	650095	lid blue, complete with lamp	Faby 1-3, Fast Cold 1-3	F300/C
3	650096	lid blue, complete with lamp and gear motor		F300



item	order no.	description	type	ref. no.
1	650063	lid at the back, blue	Faby 1-3, Fast Cold 1-3	F001BM(CF)
2	650064	lid at the back, yellow		F001/Y(CF)
3	650065	lid at the back, black		F001/N(CF)



item	order no.	description	type	ref. no.
1	650097	container		F410
2	650098	container with lever blue	Faby 1-3, Fast Cold 1-3	F302
3	650099	container with lever white		F302/N/W



item	order no.	description	type	ref. no.
1	650066	lid bottom part in the front		F005
2	650067	lid bottom part at the back		F095
3	650068	holder white	Faby 1-3, Fast Cold 1-3	F002
4	650069	holder blue		F002/BM
5	650070	holder black		F002/N

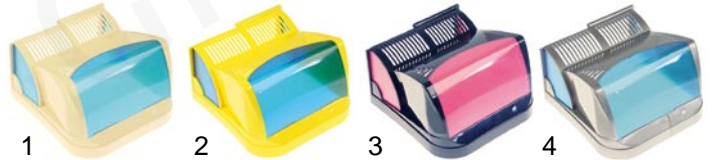

item	order no.	description	type	ref. no.
1	650071	lid in the front, white		F001BB
2	650072	lid in the front, yellow	NEW Faby 1-3, Fast Cold 1-3	F001/GB
3	650073	lid in the front, black		F001/NL
4	650074	lid in the front, grey		F001/GMB



item	order no.	description	type	ref. no.
1	650091	lid white, complete		F301/N/W
2	650092	lid white, complete with lamp	Faby 1-3, Fast Cold 1-3	F300/N/SA/W
3	650093	lid white, complete with lamp and gear motor		F300/N/OD/W



item	order no.	description	type	ref. no.
1	650075	lid at the back, blue		F001.1/BB
2	650076	lid at the back, yellow	NEW Faby 1-3, Fast Cold 1-3	F001.1/GB
3	650077	lid at the back, black		F001.1/NL
4	650078	lid at the back, grey		F001.1/GMB



item	order no.	description	type	ref. no.
1	650079	lid bottom part in the front	NEW Faby 1-3, Fast Cold 1-3	F005.1
2	650080	lid bottom part at the back		F095.1
3	650081	spindle		F238



item	order no.	description	type	ref. no.
1	650082	evaporator lid blue	NEW Faby 1-3, Fast Cold 1-3	F030BM
2	650083	evaporator lid grey		F030/GM
3	650084	evaporator lid black		F030/N
4	650085	evaporator lid yellow		F030/Y

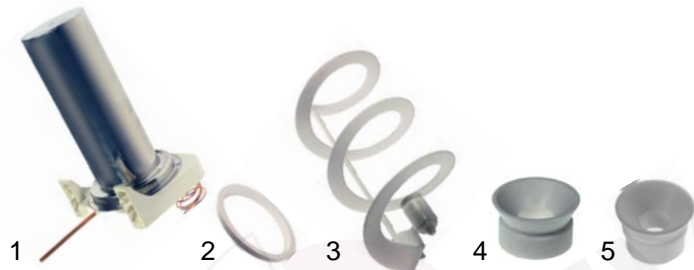

item	order no.	description	type	ref. no.
1	750184	evaporator		FEV4WT
2	650026	gasket	NEW Faby 1-3	F019
3	650054	twist complete		F304/1
4	650038	gasket (old)		F026
5	650039	gasket (new)		F026/2

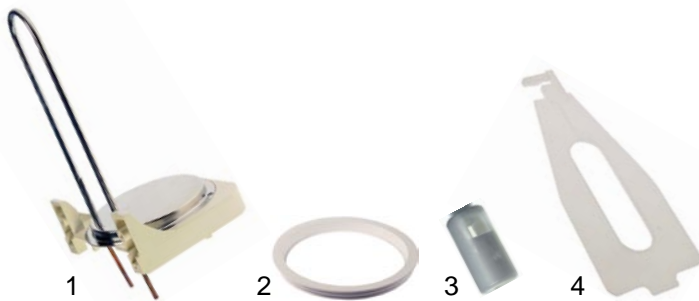

item	order no.	description	type	ref. no.
1	750187	evaporator		FB208
2	650026	gasket	Fast Cold 1-3	F019
3	650037	impulse bush		F007
4	650019	agitator arm		FB016



item	order no.	description	type	ref. no.
1	650043	brass washer		F317
2	516222	circlip		F021
3	650034	drive shaft	Faby 1-3	F303
4	650052	gasket		F022/1
5	650023	bush 19 (old)		F051
6	650045	bush 19/12 (new)		F226

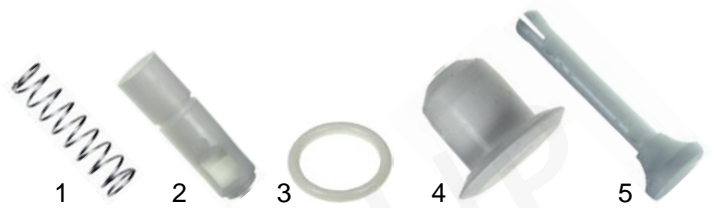

item	order no.	description	type	ref. no.
1	691113	spring		F014
2	650035	valve bush	Faby 1-3, Fast Cold 1-3	F015
3	532513	gasket		F016
4	650051	end cap		F017
5	650040	spindle		F013



item	order no.	description	type	ref. no.
1	650041	lever blue	Faby 1-3	F012BM
2	650089	lever yellow		F012/Y
3	650090	lever black		F012/N
4	650087	lever white		F012/BB
5	650088	lever black	NEW Faby 1-3	F012/NL
6	650086	lever yellow		F012/GB
7	650042	lever grey		F012GMB



item	order no.	description	type	ref. no.
1	650030	drying basin blue metallic		F059BM
2	650031	drying grid blue metallic		F060BM
3	650020	drying basin grey	Faby 1-3, Fast Cold 1-3	F059GM04
4	650021	drying grid grey		F060GM04
5	650055	drying basin blue		F059/N/B
6	650056	drying grid blue		F060/N/B

refrigeration cycle components

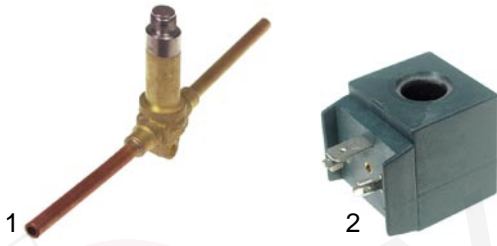

item	order no.	description	type	ref. no.
1	370392	solenoid valve body	Faby 2/3	1183
2	371189	solenoid coil		1285



item	order no.	description	type	ref. no.
1	750185	evaporator 6l	Luke 1-4	LEV6LT
	750186	evaporator 9l		LEV9LT
2	750184	evaporator	Faby 1-3	FEV4WT
3	750187	evaporator	Fast Cold 1-3	FB208



item	order no.	description	type	ref. no.
1	750229	dryer 20g	Luke 1-4 Faby 2/3, Fast Cold 2/3	1184
2	750228	dryer 20g	Faby 1, Fast Cold 1	F062

C Suitable for CAB

