



Sand filter

Pahlén sand filter for effective purification of your swimming pool water.

- High quality polyethylene
- Easy to install
- Six way valve
- Manometer
- Drain plug

The filter is made of polyethylene (HDPE), a corrosion resistant and strong material. The central valve on the filter is equipped with connections to pump, pool and drain. The filter effectively collects all impurities from the pool.

Backwashing of the filter is simple and is accomplished by turning the handle on the central valve. The water flow through the sand is then reversed and brings the dirty water out through the drain connection of the valve.

Technical data						
Item no.	Type	Filter area m ²	Sand kg	Total weight sand + water kg	Connection	Dimensions H (mm) Ø
212020	405	0,13	50	93	1½"	825 400
212021	505	0,20	100	175	1½"	915 500
212022	605	0,28	150	258	1½"	1015 600



Sand filter 520, 640, 760, 900

The filters are manufactured from GRP, a strong corrosion free material. The backwash valve is made of bronze or ABS plastic with connections to the pump, pool and drain.

These filters effectively collect all impurities from the pool and are themselves easily cleaned when necessary by a simple operation. This is accomplished by turning the handle on the backwash valve. The water flow through the sand is then reversed and the dirty water is sent to the drain outlet.



Filter medium: Screened sand 0,6-0,8 mm
 A drain plug is fitted to the tank.
 Excluding filter sand.

Bronze valve

Item.no

- 110 011 11 Sand filter 520 with 1 ½” backwash valve of bronze
- 110 021 11 Sand filter 640 with 1 ½” backwash valve of bronze
- 110 022 11 Sand filter 760 with 1 ½” backwash valve of bronze

Plastventil

- 110 011 21 Sand filter 520 with 1 ½” backwash valve of ABS plastic
- 110 021 21 Sand filter 640 with 1 ½” backwash valve of ABS plastic
- 110 022 21 Sand filter 760 with 2” backwash valve of ABS plastic
- 110 023 21 Sand filter 900 with 2” backwash valve of ABS plastic

Technical data

Item no.	Type	Filter area m ²	Sand bed depth (mm)	Max operating pressure bar	Net weight kg	Sand kg	Total weight sand + water kg	Dimensions H (mm) Ø	
Bronze valve									
110 011 11	520	0,22	430	2	25	100	183	1010	530
110 021 11	640	0,33	470	2	31	150	263	1010	650
110 022 11	760	0,45	680	2	38	225	408	1215	770
Plastic valve									
110 011 21	520	0,22	430	2	17	100	175	1060	530
110 021 21	640	0,33	470	2	23	150	254	1060	650
110 022 21	760	0,45	680	2	33	225	403	1240	770
110 023 21	900	0,64	690	2	43	325	575	1260	900



Sand filter 300 is supplied with base plate and connection hose to the pump.

Sand filter 300 (212014), pump Micro 33 (115820), plastic electric heater 1,5-3,0 kW (141650-52), connecting pipe (516403) and sand (12220) make a compact and adaptable unit for smaller swimming pools and hot tubs.

Technical data

Item no.	Type	Filter area m ²	Suitable pump size	Net weight kg	Sand kg	Pipe connection valve	Dimensions		
							H (mm)	W (mm)	W (mm)
212014	300	0,07	0,25 kW	7	20	1 ½"	745	365	635

Multibed sand filter

Multibed glass fibre polyester reinforced sand filters are supplied with lateral nozzle system, large side manhole, sight glass, pressure gauge, air bleeding and a 6-way backwash valve.

Working pressure: 2,5 bar

Test pressure: 4,0 bar

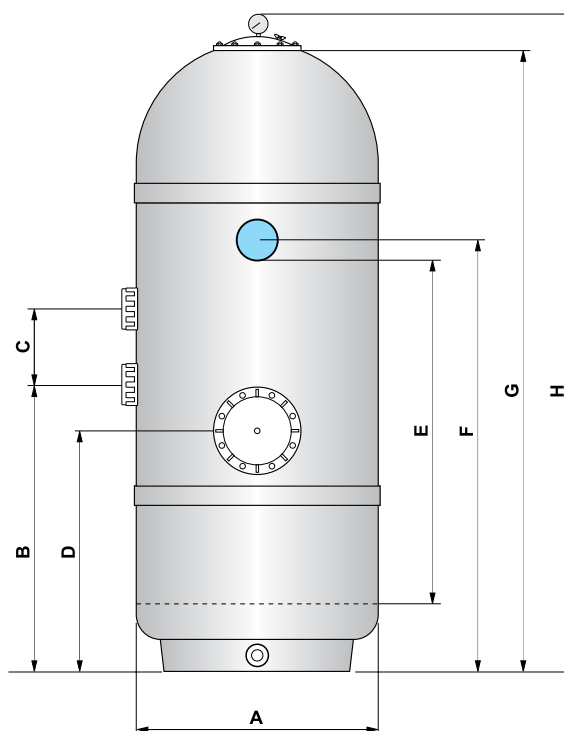

Dimensions in mm

Filter with 1000 mm sand bed

A	B	C	D	E	F	G	H
640	600	140	460	1000	1130	1140	1550
760	600	140	510	1000	1180	1490	1600
900	590	140	500	1000	1230	1510	1610

Filter with 1200 mm sand bed

640	780	140	550	1200	1455	1740	1800
760	740	140	650	1200	1455	1740	1800
900	740	140	650	1200	1455	1740	1800



Lateral nozzle system

Multibed sand filter

Item no.	Ø mm	Connection	Filter area m ²	Sand bed height mm	Sand kg
21900	640	2"	0,32	1000	475
21901	760	2"	0,45	1000	650
21902	900	2"	0,64	1000	925
21903	640	2"	0,32	1200	575
21904	760	2"	0,45	1200	800
21905	900	2"	0,64	1200	1125





Filter sand

Specially prepared sand, washed and screened for sand filters.

Item no.	Particle size mm	Weight /sack (kg)
12220	0,6-0,8	25

Other particle sizes can be supplied upon request.

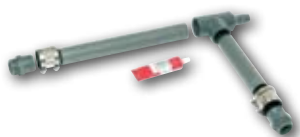

PVC connecting pipe

Connecting pipe between pump and filter for type 400, 500, 520, 600 and 640. Including couplings to pump and filter.



Item.no	
516401	PVC connecting pipe Ø 50 mm with 1/2" thermostat connection.
516402	PVC connecting pipe Ø 50 mm with 90° angle.
516403	PVC connecting pipe Ø 50 mm for sand filter 300 with pump and plastic electric heater.
516405	Connecting hose, flexible PVC Ø 50 mm.

Filter cartridges



Cartridges for filter types BF, HIF and EK

Item no.	Microns	Length (mm)	OD (mm)	ID (mm)	Max temp °C
21237	0,35	247	70	28	60
21238	1	247	70	28	60
21242	5	247	70	28	60
212420	10	247	70	28	60
21240	20	247	70	28	60
21243	50	247	70	28	60
21244	100	247	70	28	60

For swimming pools use 20 microns.



Older cartridges

Item no.	Filter type	Length (mm)	YD (mm)	ID (mm)	Max temp °C
21245	Filter cartridge type 250, 20 micron	250	175	77	60
21246	Filter cartridge type 500, 20 micron	500	175	77	60
31227	Cartridge type ST105, for vacuum cleaner trolley with singel cartridge	483	197	85	60

Filter Multibed

med rördysor/with lateral nozzles
Art.nr/Item no. 21900-21905

Sandbäddshöjd/Filtration bed: 1000 mm

Art.nr/ Item no	Ø mm	Ansl/Pipe connection	Referens
21900	640	2"	ZMC64021
21901	760	2"	ZMC76021
21902	900	2"	ZMC90021

Sandbäddshöjd/Filtration bed: 1200 mm

Art.nr/ Item no	Ø mm	Ansl/Pipe connection	Referens
21903	640	2"	ZMC64022
21904	760	2"	ZMC76022
21905	900	2"	ZMC90022

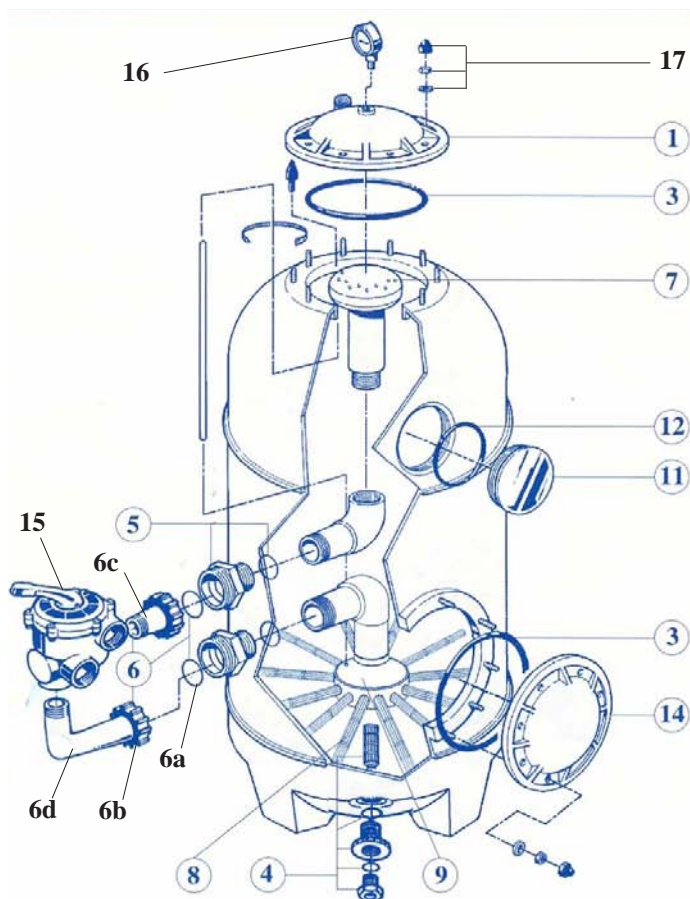

Pos.	Antal Qty	Art.nr/Item no.	Benämning	Description
1	1	2190401	Filtertopp Ø300 mm	Top lid Ø300 mm
3	1	219832	O-ring till lucka	O-ring for lid
4	1	2190404	Avtappningsplugg komplett	Drain set
4a	1	-	O-ring avtappningsplugg	O-ring
4b	1	-	Plugg	Plug
5	1	219810	Koppling 2" med O-ring	Union set 2"
5a	1	2190405	O-ring tillkoppling	O-ring for union
6	1	2190406	Anslutningsset 2" komplett	Connecting kit 2"
6a	1	2190405	O-ring 1st	O-ring 1pc
6b	1	2190420	Mutter	Nut
6c	1	2190421	Anslutning rak	Connection valve
6d	1	2190422	Anslutning vinklad	Connection elbow valve
7	1	2190407	Spridare	Diffuser
8	1*	2190308	Dysa L=170 mm	Nozzle L=170 mm
8	1*	2190408	Dysa L=220 mm	Nozzle L=220 mm
8	1*	2190508	Dysa L=275 mm	Nozzle L=275 mm
9	1	2190409	Dyscentrum för 12 dysor	Collector for 12 nozzles
11	1	219850	Siktglas	Sight glass
12	1	2190403	O-ring till siktglas	O-ring for sight glass
14	1	219830	Sidolucka Ø300 mm	Side lid Ø300 mm
15	1	219800	Sidoventil 6-vägs 2"	Side valve 6 way 2"
16	1	2190410	Manometer G¼" 3 bar	Pressure gauge G¼" 3 bar
17	1	2194017	Kupolmutter/Bricka/Packning	Nut/Washer/Gasket

* Totalt antal i dyscentrum/Total number in collector = 12 st/pcs